

### Shoulder-ended steel pipes, fittings and couplings to SANS 815-1

- The shoulder-ended system is considered flexible, where certain angular and axial movement takes place within the jointing mechanism
- Pipe size range: 50NB to 300NB
- Maximum working pressure: 25 Bar
- Light and easy to install
- SATAS permit number: 221.6/1 to apply 815-1 mark
- Full range of fabricated steel fittings
  - Bends 45°, 90°
  - Adjustable bends
  - Equal Tees 45°, 90°
  - Adaptors
  - Unequal Tees 45°, 90°
  - Reducers
  - Elbows 45°, 90°
  - Setting pieces 5°, 10°, 22.5°
  - Blank ends

Coupling Size	Max Working Pressure	Deflection from centre line/max degrees per coupling	Bolt & nut sizes
50NB	20Bar	2° 04'	M12 x 65
100NB	20Bar	2° 04'	M12 x 65
150NB	20Bar	2° 04'	M16 x 90
200NB	20Bar	2° 04'	M16 x 115
250NB	20Bar	2° 04'	M20 x 140
48mm	20Bar	2° 04'	M10 x 50
102mm	20Bar	2° 04'	M12 x 65
152mm	20Bar	2° 04'	M12 x 65

Ring-ended fabricated pipes and fittings

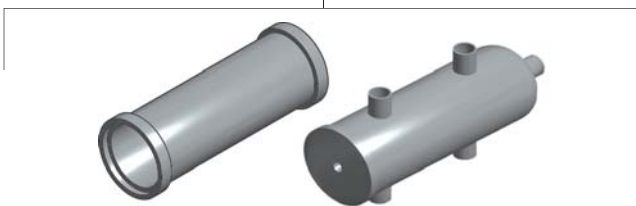

Stub-ended fabricated pipes and fittings

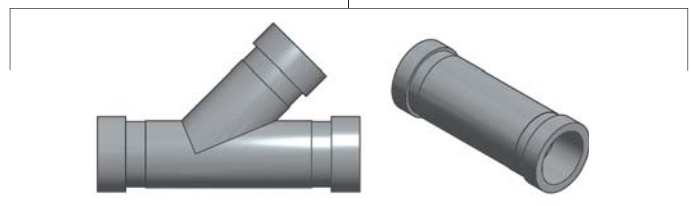

Full range of fabricated ring-ended and stub-ended fittings available

### Mac Coupling: Shoulder Cast Coupling to join ring-ended and stub-ended pipes and fittings



MAC Shoulder cast couplings

Couplings are hot dipped galvanized or painted